

DN	Pipe OD(mm)	Tol. OD&Lenght	A	B	Sleeve C x Thickness	Bolts and nuts Qty.x Dia x length	Weight(kg)	WP(bar)
50	60.3	±0.8	89	430	300x6	2xM12x430	4.1	46
65	76.1	±0.8	155	430	300x6	2xM12x430	4.6	46
80	88.9	±0.8	153	430	300x6	3xM12x430	5.6	46
100	114.3	±0.8	178	430	300x6	3xM12x430	6.5	46
125	139.7	+1.6-0.8	228	430	300x6	4xM12x430	8.8	46
150	168.3	+1.6-0.8	256	430	300x6	4xM12x430	13.4	37
200	219.1	+1.6-0.8	313	430	300x6	6xM12x430	16.9	36
250	273.1	+1.6-0.8	370	430	300x6	6xM12x430	21.1	35
300	323.9	+1.6-0.8	421	430	300x6	6xM12x430	24.5	35
350	355.6	+2.4-0.8	452	430	300x6	6xM12x430	28.2	26
400	406.4	±1.6	503	430	300x6	8xM12x430	31.6	26
450	457.2	±1.6	554	430	300x6	8xM12x430	37.2	26
500	508	±1.6	605	430	300x6	10xM12x430	39.8	26
550	558.8	±1.6	655	430	300x6	10xM12x430	46.0	26
600	609.6	±1.6	707	430	300x6	10xM12x430	49.6	24
650	660.4	±1.6	757	430	300x6	12xM12x430	61.2	24
700	711.2	±1.6	812	430	300x6	12xM12x430	67.4	24
800	812.8	±1.6	914	430	300x6	14xM12x430	76.6	20
900	914.4	±1.6	1015	430	300x6	16xM12x430	82.4	20
1000	1016	±1.6	1117	430	300x6	18xM12x430	100.6	16
1200	1219.2	±1.6	1346	430	300x6	22xM12x430	153.6	16

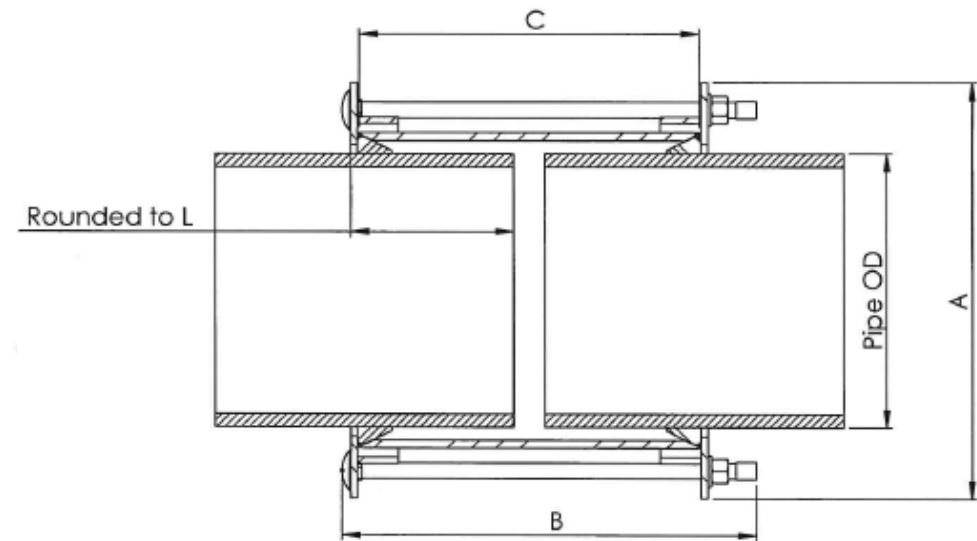
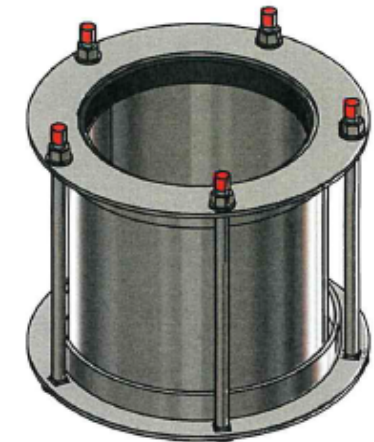

MERX TRADE B.V.
VALVES FOR MARINE AND INDUSTRY